





# **swimming pools and accessories**

Economic-Sets

Swimming pool:

Steel plate 1.20 m high, 0.45 mm thick, steel wall with perforations for skimmer and inlet nozzle, galvanized, plastic-coated on the outside, lacquered on the inside, with **swimming pool foil 0.4 mm thick, blue**

Filter system:

Suspension filter IS 6 or sand filter system Sandy 8, tank diameter 400 mm with top mount valve, pump circulation rate 7 m³/h, self-priming pump



		Article No.	
<b>Economic-Set 1</b>	Round pool ø 4 m, suspension filter IS 6	10.51.10 F	
<b>Economic-Set 2</b>	Round pool ø 4 m, sand filter system, integrated skimmer set with inlet nozzle, flange and seals	10.51.11 F	
<b>Economic-Set 3</b>	Round pool ø 5 m, suspension filter IS 6	10.51.12 F	
<b>Economic-Set 4</b>	Round pool ø 5 m, sand filter system, integrated skimmer set with inlet nozzle, flange and seals	10.51.13 F	
<b>Economic-Set 5</b>	Eight form pool 5.4 x 3.5 m, suspension filter IS 6	10.52.10 F	
<b>Economic-Set 6</b>	Eight form pool 5.4 x 3.5 m, sand filter system, integrated skimmer set with inlet nozzle, flange and seals	10.52.11 F	

**i** All our foils are thermoplastics. Temperatures constantly above 28°C can cause pleating. The maximum constant temperature for fabric-reinforced foils is 32°C.





Round swimming pools

Round pools with a galvanized steel wall 0.6 mm thick (0.8 mm for pool depths of 1.5 m).  
Also coated with polyester on the outside and protective lacquer on the inside. Aluminium slot-in profiles provide a sturdy connection of the steel wall ends, and can easily be detached again.  
PVC handrail and ground rail.  
PVC inner cover made of UV-stabilized, tearproof, cold-resistant foil, always with special MTH liner wedge profile.



Steel wall 0.6 mm / foil 0.6 mm blue									
Size	1.2 m deep		1.5 m deep		PE cover tarpaulin		Air bubble foil (round)		Provence stones *
ø m	Article No.		Article No.		Article No.		Article No.		Article No.
4.00	10.11.12 D				32.11.15 D		32.21.15 D		38.15.12 E
5.00	10.11.15 D		10.31.12 D		32.11.19 D		32.21.19 D		38.15.15 E
6.00	10.11.16 D		10.31.13 D		32.11.21 D		32.21.21 D		38.15.16 E
7.00	10.11.17 D		10.31.14 D		32.11.23 D		32.21.23 D		38.15.17 E
8.00	10.11.18 D		10.31.15 D		32.11.25 D		32.21.25 D		38.15.18 E
9.00	10.11.19 D		10.31.16 D		32.11.27 D				
10.00	10.11.20 D		10.31.17 D		32.11.28 D				

\* Transport fee for edge stones are extra and not included

Pool surcharge for all pools compared to blue foil 0.6 mm:

- Foil 0.75 mm: •Florida •Naxos 15%  
Foil 0.8 mm: •marble •pale blue •white •sand 12%;  
•blue and turquoise 8%

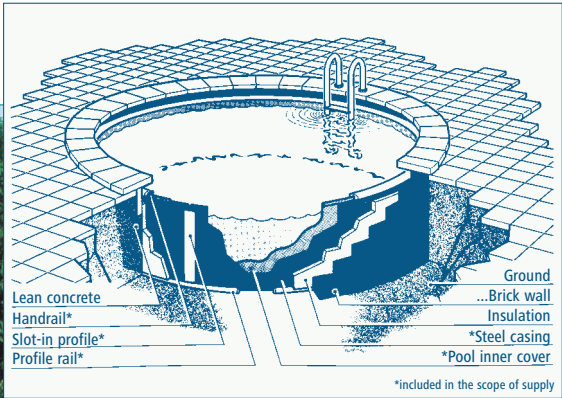

For steps: foil must be produced in a special size for steps in the round. Please always state with the order.



## Eight form swimming pool

Eight form pools with a galvanized smooth steel wall 0.6 mm thick (0.8 mm for pool depth of 1.5 m).

Also coated with polyester on the outside and protective lacquer on the inside. Aluminium slot-in profiles provide a sturdy connection of the steel wall ends, and can easily be detached again.

PVC handrail and ground rail.

PVC inner cover made of UV-stabilized, tearproof, cold-resistant foil, always with special MTH liner wedge profile. The steel structure for the eight form pool consists of vertical supports with divided cross stays. All parts are galvanized.



### Foil 0.6 mm blue

Size	1.2 m deep Steel wall 0.6 mm	1.5 m deep Steel wall 0.8 mm	PE cover tarpaulin	Air bubble foil (oval)	Provence stones *
ø m	Article No.	Article No.	Article No.	Article No.	Article No.
5.25 x 3.20	10.14.10 D	10.34.10 D	32.12.10 D	32.22.10 D	38.15.40 E
5.40 x 3.50	10.14.11 D	10.34.11 D	32.12.11 D	32.22.11 D	38.15.41 E
6.25 x 3.60	10.14.12 D	10.34.12 D	32.12.12 D	32.22.12 D	37.15.42 E
7.25 x 4.60	10.14.14 D	10.34.14 D	32.12.14 D	32.22.14 D	38.15.44 E
8.55 x 5.00	10.14.16 D	10.34.16 D	32.12.16 D	32.22.16 D	38.15.46 E
9.20 x 6.00	10.14.17 D	10.34.17 D	32.12.17 D	32.12.17 D	38.15.47 E

\* Transport fee for edge stones are extra and not included

### Pool surcharge for all pools compared to blue foil 0.6 mm:

Foil 0.75 mm: •Florida •Naxos 15%

Foil 0.8 mm: •marble •pale blue •white •sand 12%;  
•blue and turquoise 8%

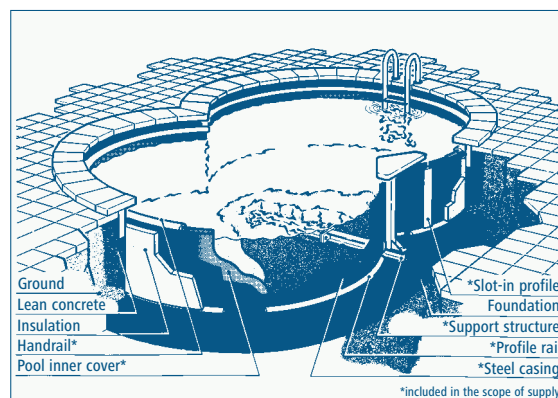

Polyester steps 1.5 mm wide. For simple installation in the steel casing. Only suitable for pools with a depth of 1.5 m. Description see [19](#)





Oval shape swimming pool

Oval swimming pool without steel structure. Only for installation in the ground with support wall made of hollow concrete bricks filled with lean concrete and steel reinforcement, or without backfilling with a special support wall made of steel elements. The swimming pool consists of a galvanized, plastic-coated steel casing 0.6 mm thick (or 0.8 mm thick for a depth of 1.50 m), peripheral PVC handrail and ground rail, PVC inner cover made of UV-stabilized, tearproof and cold-resistant foil always with - special MTH liner wedge profile.



Foil 0.6 mm blue									
Size m	1.2 m deep Steel wall 0.6 mm		1.5 m deep Steel wall 0.8 mm		PE cover tarpaulin		Provence stones *		
	Article No.		Article No.		Article No.		Article No.		
4.90 x 3.00	10.17.10 D		10.37.10 D		32.13.10 D		38.15.60 E		
6.30 x 3.60	10.17.12 D		10.37.11.D		32.13.19 D		38.15.62.E		
7.37 x 3.60	10.17.14 D		10.37.12 D		32.13.26 D		38.15.64 E		
8.00 x 4.00	10.17.15 D		10.37.14 D		32.13.28 D		38.15.65 E		
9.16 x 4.60	10.17.18 D		10.37.16 D		32.13.35 D		38.15.69 E		
9.00 x 5.00	10.17.19 D		10.37.18 D		32.13.34 D		38.15.70 E		
10.30 x 5.00	10.17.20 D		10.37.19 D		32.13.40 D		38.15.72 E		
11.00 x 5.50	10.17.21 D		10.37.20 D		32.13.41 D		38.15.73 E		

\* Transport fee for edge stones are extra and not included

Pool surcharge for all pools compared to blue foil 0.6 mm:

- Foil 0.75 mm: •Florida •Naxos 15%  
Foil 0.8 mm: •marble •pale blue •white •sand 12%;  
•blue and turquoise 8%



Polyester steps 1.5 mm wide. For simple installation in the steel casing.  
Only suitable for pools with a depth of 1.5 m.  
Description see 19

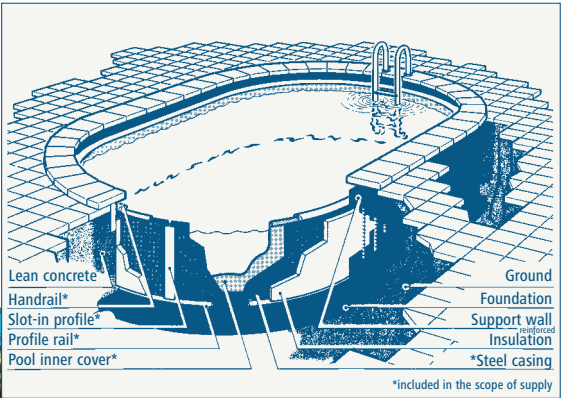

## Metal-tec

Designer swimming pool in silver-grey metallic\* to meet the very highest demands. The exclusive special edition really is a sight to be seen and is most effective in free-standing solutions or pools partly installed in the ground.

The pool consists of a galvanized steel wall 0.7 mm thick and is 1.35 m high, with perforations for skimmer and nozzle. On the outside it is coated with polyester plastic, and with protective lacquer on the inside.

Aluminium slot-in profiles provide a sturdy connection of the steel wall ends, and can easily be detached again.

The PVC handrail and ground rail are also designed in elegant silver-grey metallic\*. The PVC inner cover "Florida" made of UV-stabilized, tearproof, cold-resistant foil 0.75 mm thick with - special MTH liner wedge profile is not only elegant and stable but also practical: dirt and stains are less obvious.

\* RAL 9006



Metal-tec SUNNY POOL® is available as round pool and oval pool.

The oval pool is erected optionally with a steel structure (see support walls  13) or can be partly installed in the ground.

Alternatively, it is also possible to use a support wall made of hollow concrete bricks (filled with lean concrete) with steel reinforcement. The metallic design is particularly attractive in pools partly installed in the ground on a slope.

### Metal-tec SUNNY POOL®, foil Florida 0.75 mm

Size	1.35 deep Steel wall 0.7 mm	PE cover tarpaulin	Air bubble foil (round)
m ø / m	Article No.	Article No.	Article No.
5.00	10.23.10 D	32.11.19 D	32.21.19 D
6.00	10.23.11 D	32.11.21 D	32.21.21 D
			(oval)
7.37 x 3.60	10.29.10 D	32.13.26 D	32.23.26 D
8.00 x 4.00	10.29.11 D	32.13.28 D	32.23.28 D

A stainless steel ladder is also available to go with the Metal-tec SUNNY POOL®.

Stainless steel ladder type R for surface-mounting pools 1.35 m high, platform and steps made of white plastic.

Ladder beam diameter = 43 mm, 1.35 / 1.35, 5/5-steps

Art. No.

37.21.27 C

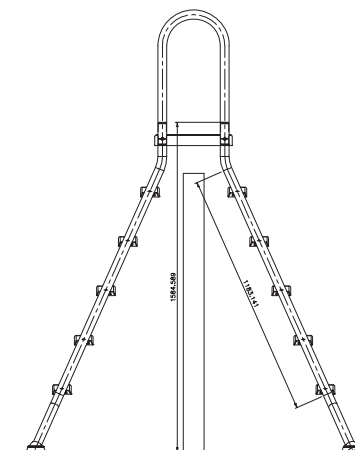



Special support wall for oval pool

This prefabricated wall made of elements of the SUNSTAR® pool can be used to install the swimming pool on a hardened concrete slab in one single move. The walls are so robust that no backfilling is necessary. The pool can be filled with water immediately.

The scope of supply includes not only the segments and vertical supports but also the top and bottom U-profiles, screws and nuts, and the heavy-duty dowels.



The support walls withstand the static water pressure. After installation, suitable material must be used for backfilling. The system does not compensate for dynamic forces resulting from use of the swimming pool, e.g. diving, so that the system cannot be erected as a surface-mounted solution without backfilling. The insulation material between support wall and steel wall must compensate at least the outer overhang of the handrail to avoid a push in of the steel wall.



Special support wall for oval pool with a depth of 1.5 m or 1.35 m for size								
Set	1.5 m deep		1.35 m deep		No. of segments		No. of vertical supports	
m	Article No.		Article No..					
6.30 x 3.60	25.33.10 F				12		6	
7.37 x 3.60	25.33.11 F		25.33.12 F		16		6	
8.00 x 4.00	25.33.13 F		25.33.14 F		16		6	
9.16 x 4.60	25.33.15 F				18		8	
9.00 x 5.00	25.33.16 F				18		8	
10.30 x 5.00	25.33.17 F				22		8	

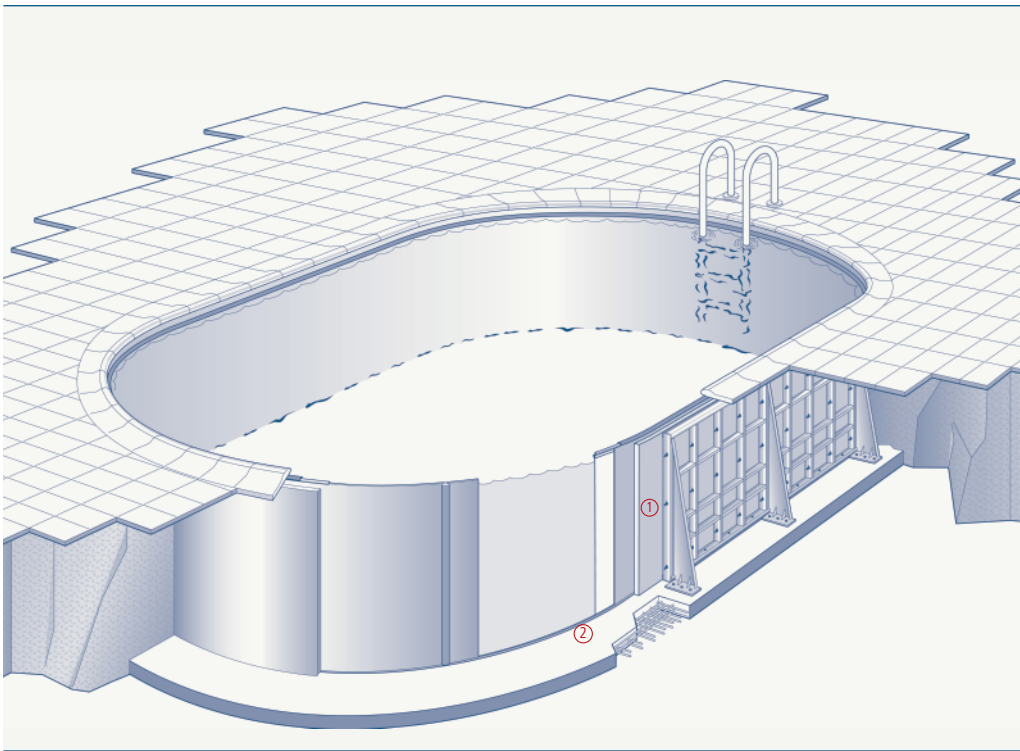

- ① Insulation (also necessary because of the ground rail)
- ② Ground rail





The SUNSTAR® pool is a prefabricated pool made of available steel segments measuring 0.5 m or 0.25 m in width and 1.5 m in height, which are screwed together. The SUNSTAR® pool can be supplied in all dimensions, based on a grid size of 0.25 m in length and width.

The segments are made of high-strength, galvanized and plastic-coated steel. This modern material was developed for the automotive industry, and offers not only the greatest possible strength but also a high level of corrosion resistance. As a result, the elements offer high stiffness values while at the same time reducing the weight. One element weighs only just 13 kg.

The high corrosion resistance gives the whole system a long service life, so that we give a 10-year guarantee on the pool against rusting through\* and also on the imperviousness of the foil (the guarantee does not cover discolouring and pleating). As a rule, the lining consists of a blue prefabricated swimming pool liner 0.8 mm thick.

It goes without saying that a SUNSTAR® pool can also be lined with fabric reinforced foil 1.5 mm thick. In this case, the prefabricated inner liner is omitted.

Condition: No damaging on transport and assembly



Go to [www.mth-sunnypool.com/downloads](http://www.mth-sunnypool.com/downloads) to see the SUNNY POOL SUNSTAR® video!



(picture below): SUNSTAR® with Roman steps made of polyester.



## Scope of delivery

### 1. Pool

Galvanized, plastic-coated high-strength steel elements 0.5 m wide and 1.5 m high, + 1 element with skimmer cut-out for skimmer type 111 (Astral)

- 2 elements with nozzle cut-out for inlet nozzle
- 4 galvanized steel corner supports, steel interim supports at least every 2 m
- Galvanized and plastic-coated U-profiles to take the steel segments at the top and bottom
- Galvanized hex screws M10 with nuts and washers, heavy-duty dowels for fastening the corner and interim supports and steel segments to the concrete base slab
- Screws for fastening the suspension profiles
- Hard PVC fastening profile for fitting the wedge liner profile
- Keder to seal the profile for fitting the wedge liner profile (makes a neat finish and holds the wedge liner profile securely)
- 4 corner pieces (hard PVC fastening profiles bent into a quadrant shape so that the wedge liner profile can be fitted easily in the corners)
- 4 profiles of polyethylene foam, 1.5 m long, rounded (for adhering in the vertical pool corner)
- Pool inner cover, blue, 0.8 mm with wedge liner profile

### Note:

See page 19 for sets of installation parts in various different versions (not included in the price).

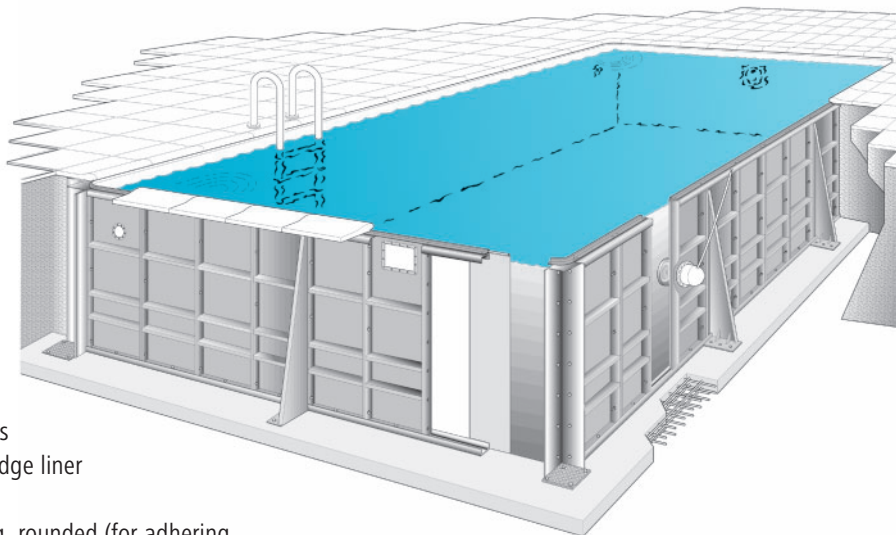

**Pool surcharge for all pools compared to blue foil 0.8 mm:**

**Foil 0.75 mm:** •Florida •Naxos 4.5%

**Foil 0.8 mm:** •marble •pale blue •white 2.5%, •turquoise without surcharge

Pool depth 1.5 m					
Pool size		Approx. volume		Edge stones colour	
				Provence light	
m	m <sup>3</sup>	Article No.		Article No.	
6.0 x 3.0	27	11.21.10 F		38.12.28 E	
6.5 x 3.0	29	11.21.11 F		38.12.29 E	
6.5 x 3.5	34	11.21.12 F		38.12.30 E	
7.0 x 3.5	37	11.21.13 F		38.12.31 E	
7.5 x 3.5	39	11.21.14 F		38.12.32 E	
7.0 x 4.0	42	11.21.15 F		38.12.33 E	
7.5 x 4.0	45	11.21.16 F		38.12.34 E	
8.0 x 4.0	48	11.21.17 F		38.12.35 E	
8.0 x 4.5	54	11.21.18 F		38.12.36 E	
8.0 x 5.0	60	11.21.19 F		38.12.37 E	
8.5 x 4.5	57	11.21.20 F		38.12.38 E	
9.0 x 4.5	60	11.21.21 F		38.12.39 E	
9.0 x 5.0	67	11.21.22 F		38.12.40 E	
9.5 x 5.0	71	11.21.23 F		38.12.41 E	
10.0 x 5.0	75	11.21.24 F		38.12.42 E	
12.0 x 6.0	108	11.21.25 F		38.12.43 E	
Steel elements 0.25 m wide		25.34.11 F			
Steel elements 0.5 m wide		25.34.10 F			



## SUNSTAR® POOL with overflow channel

The successful SUNSTAR® range has undergone further development for even greater convenience and safety.

An overflow channel which fits perfectly with the SUNSTAR® structure improves safety aspects as well as keeping the water surface clean and enhancing pool hydraulics, thus improving the water quality.

Like the SUNSTAR® pool itself, the overflow channel is produced in Germany, thus vouching for the best possible quality and design.

The steel segments are designed in the same way as the SUNSTAR® pool but are somewhat shorter. The overflow channel is simply fitted onto the mounted segments and connected to the edges of the segments. If the segments have been carefully aligned, there will be no further need to adjust the overflow channel.

### Standard channel grating

200 mm wide.

The grating bars lie longitudinal in the direction of water movement. (not illustrated)

### Channel grating de luxe

200 mm wide. The grating bars of this extremely robust and elegant channel cover lie crosswise to the direction of water movement. This prevents water from spilling over to a great extent, as the design functions more-or-less like a mini breakwater. This results in even lower water consumption levels.



### The advantages at a glance

- Better extraction of the water surface
- Greater safety because the system prevents water from spilling over
- Installation of an overflow tank greatly reduces water losses because the overflowing water is cleaned and returned to the pool
- Swimming becomes an incomparable experience because the pool has no raised edge to hinder visibility



The standard overflow channel edge is semi-circular. This not only looks good but offers the additional advantage of better guidance when covering the pool with a roller shutter system. Please ask for an individual offer.

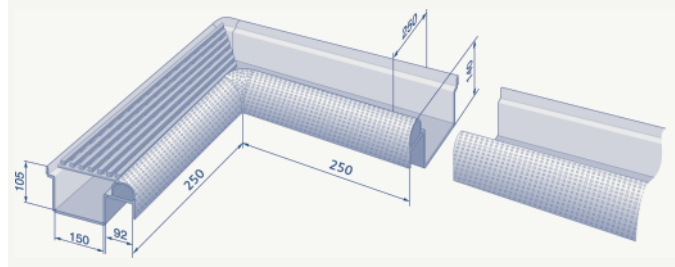

## Scope of delivery

### 1. Pool

- Galvanized, plastic-coated high-strength steel elements 0.5 m
- 4 galvanized steel corner supports, steel interim supports at least every 2 m
- Galvanized and plastic-coated U-profiles to take the steel segments at the bottom
- Galvanized hex screws M10 with nuts and washers
- Heavy-duty dowels for fastening the corner and interim supports and steel segments to the concrete base slab
- Cut-out for jet or underwater lights(surcharge)

### 2. Overflow channel system

- 4 corner pieces with inner leg length 250 mm
- Straight elements measuring 2000 mm, 1000 mm and 500 mm in length
- The overflow edge is semi-circular.
- The swimming pool foil is pushed under the foil at the overflow channel and welded in position.
- **The SUNSTAR POOL® with overflow channel cannot be supplied with a prefabricated liner.**
- 3 channel systems are available for public use.  
The overflow edge is then designed similar to the Finnish overflow channel (prices on request), not illustrated.

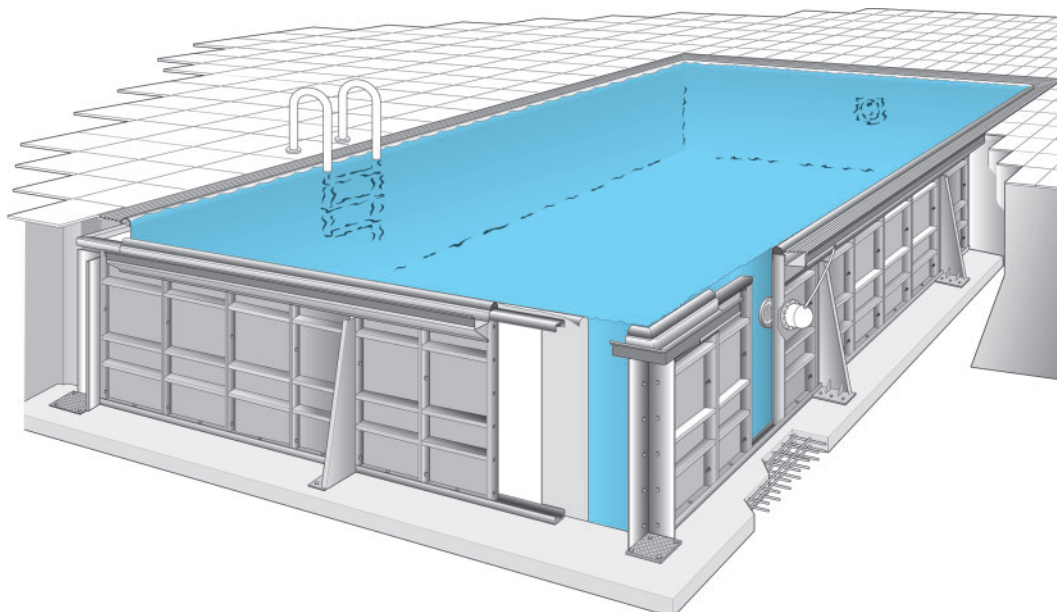

Pool depth 1.34 m *							
Pool size		Approx. volume		Channel grating Standard		Channel grating de Luxe	
m	m <sup>3</sup>		Article No.		Article No.		Article No.
6.0 x 3.0	24		11.24.10 F		25.92.10 E		25.92.11 E
6.5 x 3.0	26		11.24.11 F		25.92.12 E		25.92.13 E
6.5 x 3.5	30		11.24.12 F		25.92.14 E		25.92.15 E
7.0 x 3.5	33		11.24.13 F		25.92.16 E		25.92.17 E
7.5 x 3.5	35		11.24.14 F		25.92.18 E		25.92.19 E
7.0 x 4.0	38		11.24.15 F		25.92.20 E		25.92.21 E
7.5 x 4.0	40		11.24.16 F		25.92.22 E		25.92.23 E
8.0 x 4.0	43		11.24.17 F		25.92.24 E		25.92.25 E
8.0 x 4.5	48		11.24.18 F		25.92.26 E		25.92.27 E
8.0 x 5.0	54		11.24.19 F		25.92.28 E		25.92.29 E
8.5 x 4.5	51		11.24.20 F		25.92.30 E		25.92.31 E
9.0 x 4.5	54		11.24.21 F		25.92.32 E		25.92.33 E
9.0 x 5.0	60		11.24.22 F		25.92.34 E		25.92.35 E
9.5 x 5.0	64		11.24.23 F		25.92.36 E		25.92.37 E
10.0 x 5.0	67		11.24.24 F		25.92.38 E		25.92.39 E
12.0 x 6.0	97		11.24.25 F		25.92.40 E		25.92.41 E
Steel elements 0.25 m wide			25.35.13 F				
Steel elements 0.5 m wide			25.35.10 F				

\* Pool depth of 1,5 m available on request



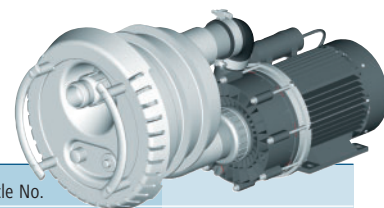

	Article No.	
<b>Set of installation parts, plastic (Astral)</b>		
Plastic skimmer, plastic inlet nozzles 2 x, floor drain plastic	11.29.21 C	
<b>Set of installation parts, plastic (OWM)</b>		
Plastic skimmer, plastic inlet nozzles 2x (Astral), floor drain plastic	36.49.10 C	
<b>Set of installation parts stainless steel (V4A), made in Germany</b>		
Fitted skimmer B280 with sieve insert, flange and seal, stainless steel inlet nozzles with set of locking parts, floor drain stainless steel type 190	11.29.22 D	
<b>Swim-Jet (Speck) set ready for installation.</b>		
Flooding system, round fitting made of plastic complete with PN switching device, Connection set with integrated mounting bracket, power output: 2.6 kW three-phase current, power consumption: 3.3 kW three-phase current, pumping rate 50 m³/h, see  84	37.82.36 D	
<b>Set of installation parts</b> , installation depth 240 mm, including plastic flange set	37.82.35 D	
<b>Console</b>	37.89.25 D	

<b>Set of underwater lights, plastic (Astral)</b>		
<ul style="list-style-type: none"> <li>• 2 plastic underwater lights with flange (Art. No. 37.71.10)</li> <li>• Transformer 600 VA (Art. No. 37.79.31)</li> <li>• 2 plastic connection boxes (Art. No. 37.79.26)</li> <li>• Cut-outs for 2 underwater lights (Art. No. 11.29.11)</li> </ul>	37.72.10 C	
<b>Set of underwater lights, plastic (OWM)</b>		
<ul style="list-style-type: none"> <li>• 2 plastic underwater lights with flange (Art. No. 37.74.11)</li> <li>• Transformer 600 VA (Art. No. 37.79.31)</li> <li>• 2 plastic connection boxes (37.74.32)</li> </ul>	37.72.14 C	
<b>Set of underwater lights, stainless steel</b>		
2 underwater underwater lights 12V/300W, 2 flanges for UWS, 2 distribution boxes, 2 cut-outs in steel segment, transformer 600 VA	37.72.13 C	
<b>Cut-out for jet or underwater lights in the Swim-tec® range</b>		
<b>Cut-out for GSA (11.29.10), UWS (11.29.11)</b>		
<b>Cut-out for skimmer (11.29.13), nozzle (11.29.14)</b>		
<b>Cut-out for other parts on request</b>	11.29.12 F	

<b>Roman steps</b>		
We offer three attractive versions of Roman steps for our SUNSTAR® POOL, made of polyester, measuring 1.5 m, 2.5 m and 3 m in width. Standard colour white with steps in contrasting blue.		
<b>Steps 1.5 m wide</b>	11.29.17 F	
<b>Steps 2.5 m wide</b>	11.29.16 F	
<b>Steps 3 m wide</b>	11.29.15 F	
<b>Corner steps</b> (only for use with 1.5 mm foil)		
2.0 x 2.0 m for SUNSTAR® POOL. White, steps azure blue	11.29.23 F	

<b>Special element for 1.5 m pool depth</b>		
Segment 25 cm wide may be necessary to fit installed parts in the middle	25.34.11 F	
Segment 50 cm wide	25.34.10 F	

Polyester steps

Steps made of fibreglass reinforced polyester with foil flange. These steps are essentially identical with the step system in the Swim-tec® pool. But equipped with foil flange and thus suitable for nearly all pool designs lined with foil or with an inner cover. For example, SUNSTAR® POOL, pool made of polystyrene elements or also brick wall pools.

The back of the steps are equipped with two robust steel pipe supports which can be adjusted in height exactly to the size of the pool. Each flange comes with two wall anchors for pools with brick walls or made of polystyrene elements.

Three sizes of steps are available:  
2.5 m, 3.0 m and 1.5 m wide. The small steps can also be used for all round, oval and eight form SUNNY POOL®'S (height 1.5 m).



Standard colour: white with blue contrasting steps. Number of steps: 4 steps; steps including wooden transport packaging.

Size	White with blue steps	Pale blue with white steps	Medium blue with white steps
W x D x H	Article No.	Article No.	Article No.
3.0 m x 1.25 m x 1.5 m	37.23.10 F	37.23.11 F	37.23.12 F
2.5 m x 1.0 m x 1.5 m	37.23.13 F	37.23.14 F	37.23.15 F
1.5 m x 1.0 m x 1.5 m	37.23.16 F	37.23.17 F	37.23.18 F
Corner steps (only for use with 1.5 mm foil)			
2.00 x 2.00 x 1.50 m with inner steps	37.23.19 F	37.23.20 F	37.23.21 F

Freight charge are not included

**Note**

Any bleaching or discolouring caused by the effects of direct sunlight and water care chemicals are not covered by the guarantee.

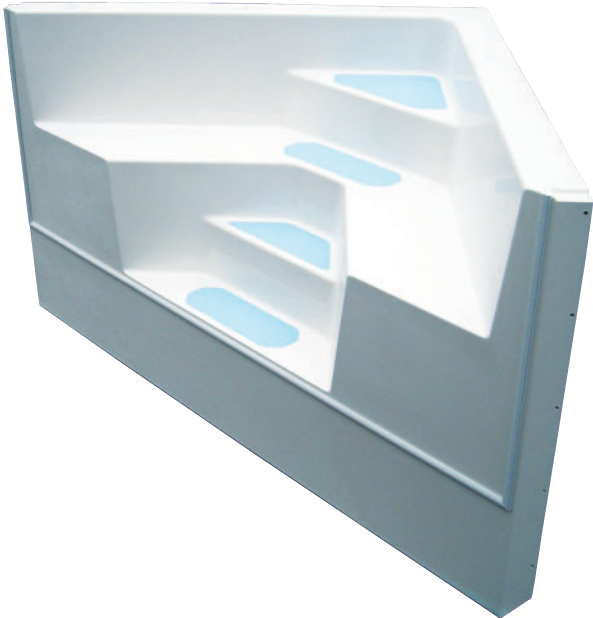



## Polyester steps

37.23.16

37.23.17

37.23.18

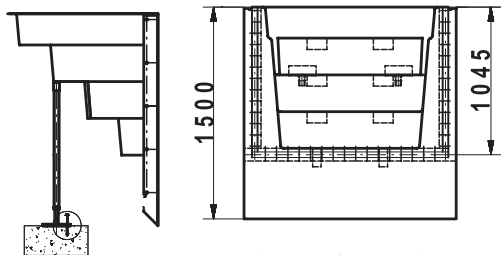
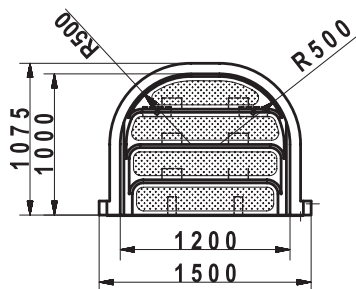

1.5 m x 1.0 m x 1.5 m

37.23.13

37.23.14

37.23.15

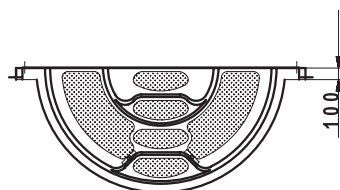
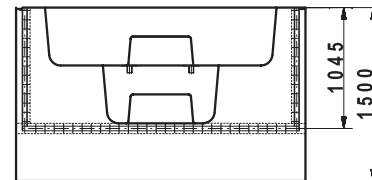
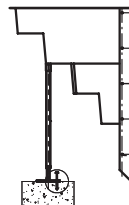
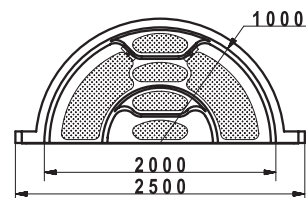

2.5 m x 1.0 m x 1.5 m

37.23.10

37.23.11

37.23.12

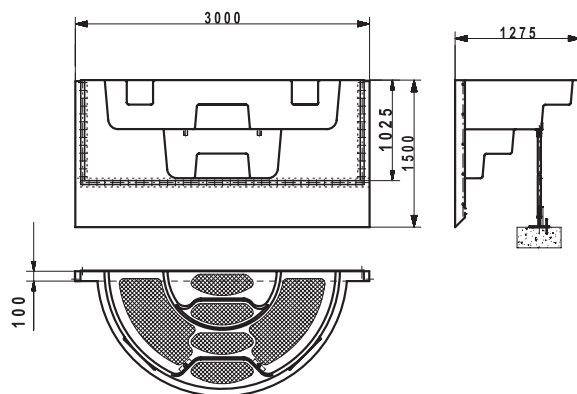
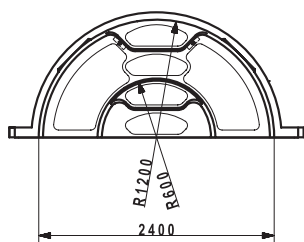

3.0 m x 1.25 m x 1.5 m

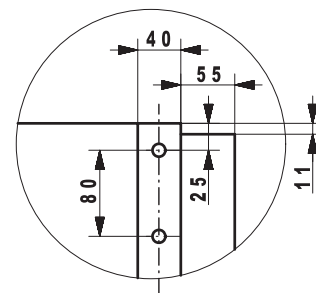

nut M10 DIN 934

washer 10 DIN 9021

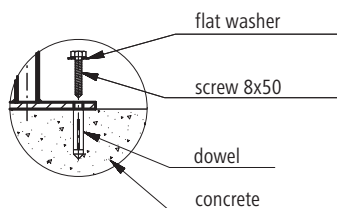
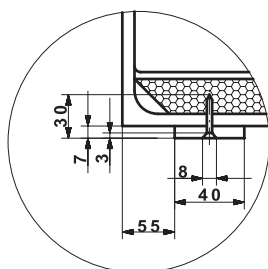
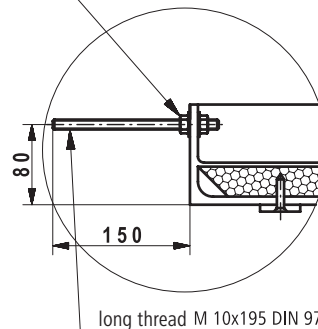

stairs, 1500 mm high  
can be shortened to 1200 mm

PVC profile

wooden wedge

profile 40x100x2

6x30 DIN 7982

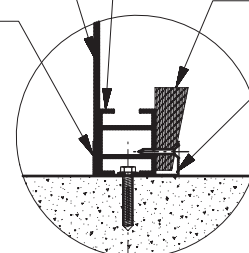



**WE CREATE HOLIDAY** ...take a rest.

INNOVATIVE PRODUCTS FOR YOUR POOL



[www.mth-sunnypool.com](http://www.mth-sunnypool.com)